

Um kV	Rated power frequency withstand voltage acc. to IEC 273 kV	Lighting Impulse Withstand voltage (peak) kV
12	28	75
24	50	125
36	70	170

SPECIFICATIONS

Type	Code	Weight kg	Um kV	Min. bending P-daN	Dimensions (mm)															Min. Creepage mm	Rippes
					H	e	s	D1	D2	D3	d1	d2	d3	d4	t1	t2	t3	t4	t5		
HPI 10	HPI 10/350	0.62	12	350	130	36	50	75	65	55	M16	M12	M6	10	25	25	9	40	5	235	5
HPI 20	HPI 20/350	1.25	24	350	225	36	50	85	75	55	M16	M12	M6	10	25	25	9	40	5	390	9
HPI 30	HPI 30/350	1.85	36	350	310	36	50	90	80	55	M16	M12	M6	10	25	25	9	40	5	550	13

VOLTAGE DIVIDER INSULATORS (CAPACITIVE)

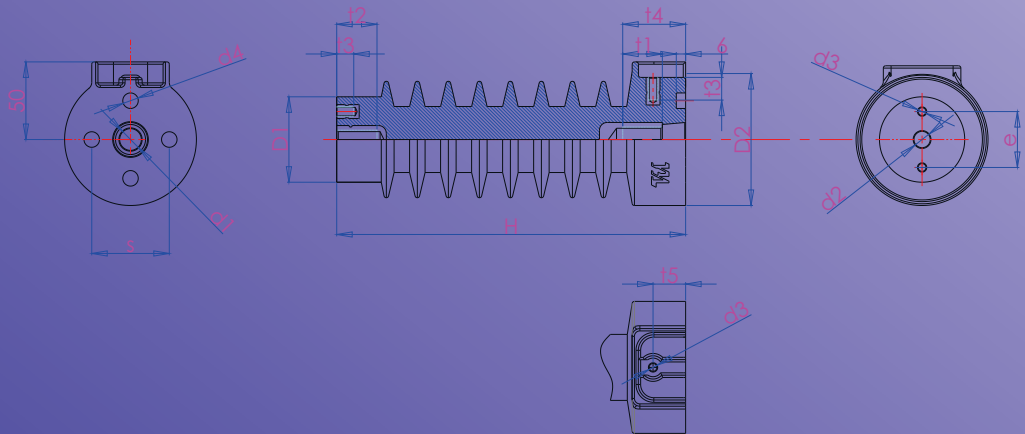
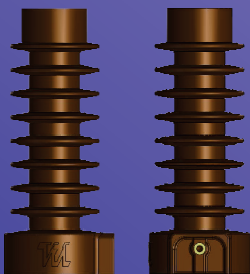

SPECIFICATIONS

Type	Code	Weight kg	Um kV	Min. bending P-daN	Dimensions (mm)															Min. Creepage mm	Rippes
					H	e	s	D1	D2	D3	d1	d2	d3	d4	t1	t2	t3	t4	t5		
HCI 10	HCI 10/350	0.77	12	350	130	36	50	75	65	55	M16	M12	M6	10	25	25	9	40	5	235	5
HCI 20	HCI 20/350	1.30	24	350	225	36	50	85	75	55	M16	M12	M6	10	25	25	9	40	5	390	9
HCI 30	HCI 30/350	2.06	36	350	310	36	50	90	80	55	M16	M12	M6	10	25	25	9	40	5	550	13

IN BRIEF

Voltage indicator works with the help of capacitive voltage dividers on modular cubicle panels.

It is used to show whether there is phase voltage for each phase. Moderate voltage values are taken into consideration to obtain maximum safety.

There are 3 indicators for each phase separately on it. In addition for the purpose of measurement, 3 phase + ground ends are located into the front panel safely and voltage level can be measured by measuring devices externally.

All the voltage inputs of DVI are saved by surge protector. Leds are used in indicators and the led has a lifetime of 100.000 hours.

Back terminal connections have sockets so it makes mounting and cabling easier



TECHNICAL FEATURES

Operating voltage	2 kV-40 kV by capacitive voltage divider
Indicator	Led 100.000 hours
Measuring probe point	4 (For 3 phase and ground separately)
Mounting	Through the front cover of the panel
Cable cross-section	2.5 sq. mm
Operating temperature	-30 °C + 85 °C
Protection class	IP 20
Weight	0.05 kg
Dimensions	36 x 62 x 45

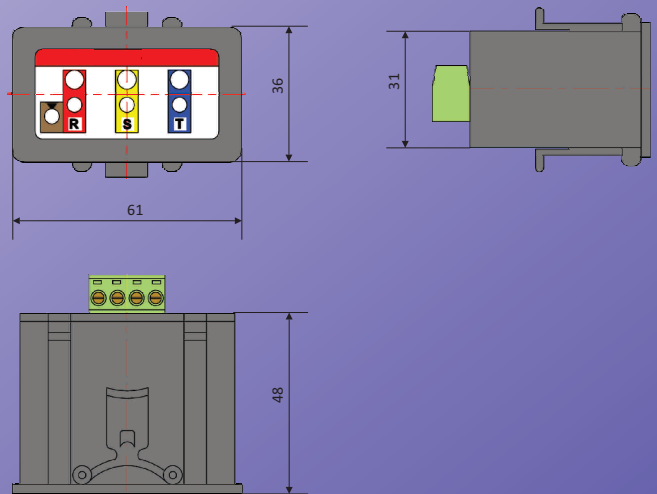

Capacitance - Coupled Voltage Indication System & Connection Diagram

Connection Diagram

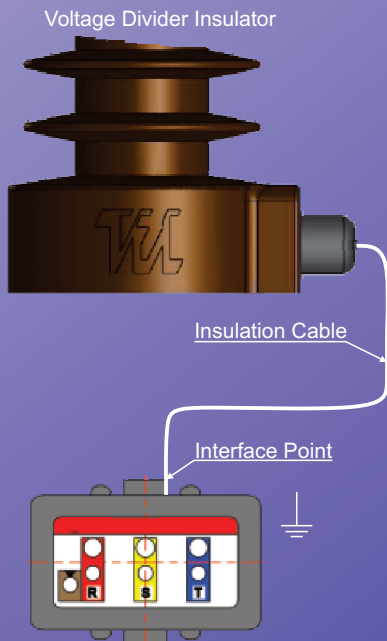

Capacitance-Coupled Voltage Indication System

